

**OGP300**

OGP-DPKG/US100

Photoelectric sensors

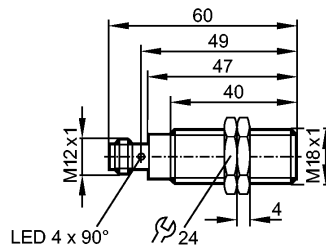

Made in Germany



**Product characteristics**

Retro-reflective sensor
Threaded type
M18 x 1
Connector
Polarisation filter
Sensing range 0.03...4m (Prismatic reflector Ø 80 (E20005))

**Electrical data**

Electrical design	DC PNP
Operating voltage [V]	10...36 DC
Current consumption [mA]	15
Type of light	Red light 624 nm
Protection class	II
Reverse polarity protection	yes

**Outputs**

Output function	dark-on mode
Voltage drop [V]	< 2.5
Current rating [mA]	200 (...60 °C) / 150 (...80 °C)
Short-circuit protection	pulsed
Overload protection	yes
Switching frequency [Hz]	1000

**Range**

Sensing range [m]	0.03...4 (Prismatic reflector Ø 80 (E20005))
Light spot diameter [mm]	160 ( at maximum range )

**Excess gain graphs**

**OGP300**

OGP-DPKG/US100

Photoelectric sensors

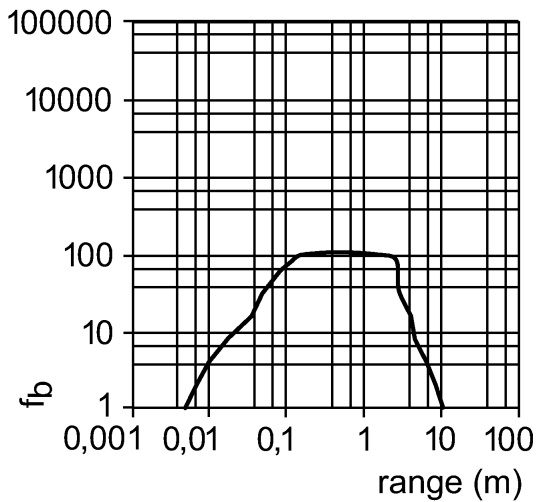

**Environment**

Ambient temperature	[°C]	-25...80
Protection		IP 67 / IP 68 / IP 69K

**Tests / approvals**

EMC		EN 60947-5-2
MTTF	[Years]	509

**Mechanical data**

Housing materials		housing: stainless steel 316L / 1.4404; sealing: EPDM
Lens material		PMMA
Weight	[kg]	0.058

**Displays / operating elements**

Output status indication	LED	yellow
--------------------------	-----	--------

**Electrical connection**

Connection		M12 connector
------------	--	---------------

**Wiring**

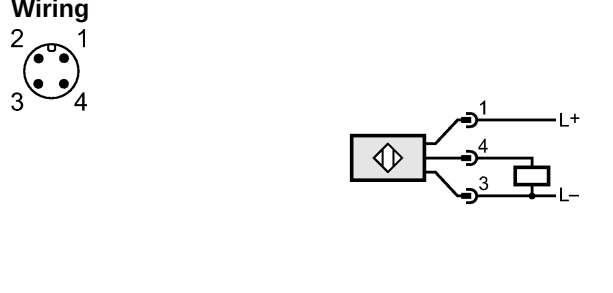

**Accessories**

Accessories (included)		2 lock nuts
------------------------	--	-------------

**Remarks**

Remarks		cULus - Class 2 source required
---------	--	---------------------------------

Pack quantity	[piece]	1
---------------	---------	---