

OGE301

OGE-HPKG/US100

Photoelectric sensors

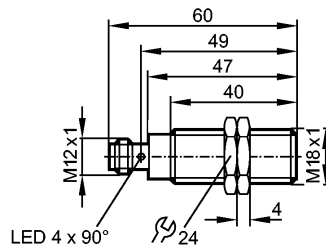

Made in Germany



Product characteristics

Through-beam sensor
Threaded type
M18 x 1
Connector
Receiver
Sensing range 20m

Electrical data

Electrical design	DC PNP
Operating voltage [V]	10...36 DC
Current consumption [mA]	10
Type of light	Red light 624 nm
Protection class	II
Reverse polarity protection	yes

Outputs

Output function	light-on mode
Voltage drop [V]	< 2.5
Current rating [mA]	200 (...60 °C) / 150 (...80 °C)
Short-circuit protection	pulsed
Overload protection	yes
Switching frequency [Hz]	1000

Range

Sensing range [m]	20
-------------------	----

Excess gain graphs

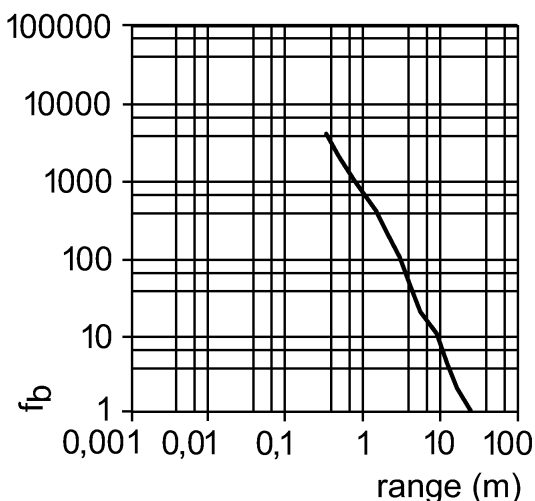

OGE301

OGE-HPKG/US100

Photoelectric sensors

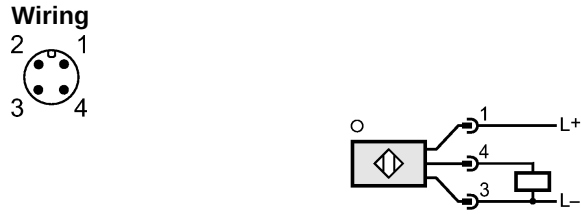
Environment		
Ambient temperature	[°C]	-25...80
Protection		IP 67 / IP 68 / IP 69K
Tests / approvals		
EMC		EN 60947-5-2
MTTF	[Years]	1067
Mechanical data		
Housing materials		housing: stainless steel 316L / 1.4404; sealing: EPDM
Lens material		PMMA
Weight	[kg]	0.059
Displays / operating elements		
Output status indication	LED	yellow
Electrical connection		
Connection		M12 connector
Wiring 		
Accessories		
Accessories (included)		2 lock nuts
Remarks		
Remarks		cULus - Class 2 source required
Pack quantity	[piece]	1