

O6S300

O6S-00KG

Photoelectric sensors

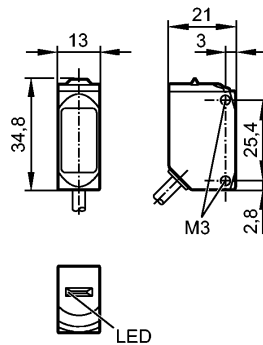

Made in Germany



Product characteristics

Through-beam sensor

Rectangular Metal

Cable

Transmitter

Sensing range 10m

Electrical data

Electrical design	DC
Operating voltage [V]	10...30 DC
Current consumption [mA]	11 (24 V)
Type of light	Red light 633 nm
Protection class	III

Range

Sensing range [m]	10
Light spot diameter [mm]	300 (at maximum range)

Excess gain graphs

x: distance in [mm]
y: excess gain factor

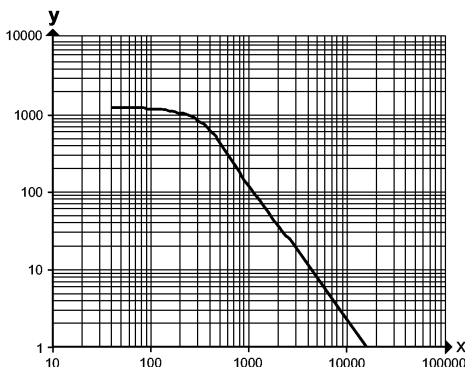

Environment

Ambient temperature [°C]	-25...80
Protection	IP 65 / IP 67 ; IP 68 / IP 69K

Tests / approvals

EMC	EN 60947-5-2
MTTF [Years]	2600
UL approval number	E004

Mechanical data

O6S300

O6S-00KG

Photoelectric sensors

Housing materials	housing: stainless steel 316L / 1.4404; plastics: PPSU
Lens material	PMMA
Weight [kg]	0.079

Displays / operating elements

Operation	LED	green
-----------	-----	-------

Electrical connection

Connection	PVC cable / 2 m; 2 x 0.25 mm ²
------------	---

Wiring

Core colours

BN brown

BU blue

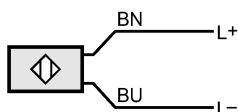

Remarks

Remarks	UL - Class 2 source required
---------	------------------------------

Pack quantity [piece]	1
-----------------------	---