

**IGS207**

IGB3012-APKG/M/US-104-DPO

**Inductive sensors**

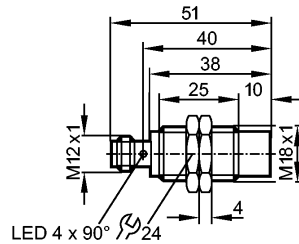

Made in Germany



**Product characteristics**

Inductive sensor
Metal thread M18 x 1
Connector
Increased sensing range
Gold-plated contacts
Sensing range 12 mm; [nf] non-flush mountable

**Electrical data**

Electrical design	DC PNP
Operating voltage [V]	10...36 DC
Current consumption [mA]	< 10
Protection class	II
Reverse polarity protection	yes

**Outputs**

Output function	Normally closed
Voltage drop [V]	< 2.5
Current rating [mA]	100
Short-circuit protection	pulsed
Overload protection	yes
Switching frequency [Hz]	300

**Range**

Sensing range [mm]	12
Real sensing range (Sr) [mm]	12 ± 10 %
Operating distance [mm]	0...9.7

**Accuracy / deviations**

Correction factors	mild steel = 1 / stainless steel approx. 0.7 / brass approx. 0.5 / Al approx. 0.4 / Cu approx. 0.3
Hysteresis [% of Sr]	3...15
Switch-point drift [% of Sr]	-10...10

**Environment**

Ambient temperature [°C]	-25...70
Protection	IP 67

**Tests / approvals**

EMC	EN 61000-4-2 ESD: 4 kV CD / 8 kV AD
	EN 61000-4-3 HF radiated: 10 V/m (80...1000 MHz)
	EN 61000-4-4 Burst: 2 kV
	EN 61000-4-6 HF conducted: 10 V (0.15...80 MHz)
	EN 55011: class B

## IGS207

IGB3012-APKG/M/US-104-DPO

Inductive sensors

MTTF	[Years]	1935
------	---------	------

### Mechanical data

Mounting	non-flush mountable	
Housing materials	Brass white bronze coated; active face: PBT (Pocan)	
Weight	[kg]	0.045

### Displays / operating elements

Output status indication	LED	yellow (4 x 90°)
--------------------------	-----	------------------

### Electrical connection

Connection	M12 connector; Gold-plated contacts	
------------	-------------------------------------	--

### Wiring

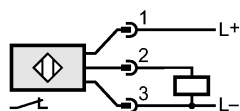

### Accessories

Accessories (included)	2 lock nuts	
------------------------	-------------	--

### Remarks

Pack quantity	[piece]	1
---------------	---------	---