

**IE5288**

IEK3004-BPKG/US-104-DPS

**Inductive sensors**

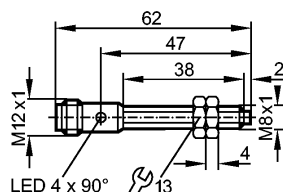

Made in Germany



**Product characteristics**

Inductive sensor
Metal thread M8 x 1
Connector
Increased sensing range
Sensing range 4 mm; [nf] non-flush mountable

**Electrical data**

Electrical design	DC PNP
Operating voltage [V]	10...36 DC; "supply class 2" to cULus.
Current consumption [mA]	< 15 (24 V)
Protection class	III
Reverse polarity protection	yes

**Outputs**

Output function	normally open
Voltage drop [V]	< 2.5
Current rating [mA]	200
Short-circuit protection	pulsed
Overload protection	yes
Switching frequency [Hz]	300

**Range**

Sensing range [mm]	4
Operating distance [mm]	0...3.25

**Accuracy / deviations**

Correction factors	mild steel = 1 / stainless steel approx. 0.7 / brass approx. 0.4 / Al approx. 0.3 / Cu approx. 0.2
Hysteresis [% of Sr]	1...15

**Environment**

Ambient temperature [°C]	-25...70
Protection	IP 67

**Tests / approvals**

EMC	EN 60947-5-2 EN 55011: class B
MTTF [Years]	3491

**Mechanical data**

Mounting	non-flush mountable
Housing materials	Brass white bronze coated; active face: CO-PC
Weight [kg]	0.025

**Displays / operating elements**

**IE5288**

IEK3004-BPKG/US-104-DPS

**Inductive sensors**

Output status indication	LED	yellow (4 x 90°)
--------------------------	-----	------------------

**Electrical connection**

Connection	M12 connector
------------	---------------

**Wiring**

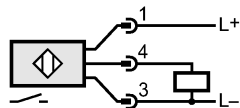

**Accessories**

Accessories (included)	2 lock nuts
------------------------	-------------

**Remarks**

Pack quantity	[piece]	1
---------------	---------	---