



DATA SHEET

# PST



## Manostats



Range from  $\pm 100$  Pa to  $\pm 2000$  mbar (according to model)



Visual and audible alarm, red led in front

### Features

- RCR relay output 3A/240 Vac (NC), power supply 24 Vac/Vdc
- ABS V0 IP65 housing
- "1/4 turn" system mounting with wall-mount plate
- Housing with simplified mounting system
- Solenoid valve for auto-calibration (only on PST-11 model)



### Measured parameter

Parameter	Accuracies*	Measuring ranges	Resolution
Pressure	PST-11: $\pm 1\%$ of reading $\pm 2$ Pa PST-12: $\pm 1.5\%$ of reading $\pm 3$ Pa PST-13: $\pm 1.5\%$ of reading $\pm 3$ mmH <sub>2</sub> O PST-14 and PST-15: $\pm 1.5\%$ of reading $\pm 3$ mbar	From -100/+100 Pa to -2000/+2000 mbar (according to model)	PST-11, PST-12 and PST-13: 1 Pa, 0.1 mmH <sub>2</sub> O, 0.01 inWG, 0.01 mmHG, 0.1 daPa, 0.001 kPa (0.01 kPa for PST-13), 0.01 hPa, 0.01 mbar PST-14 and PST-15: 1 mbar, 0.1 inWG, 1 mmHG, 0.1 PSI, 1 mmH <sub>2</sub> O, 1 daPa, 1 hPa, 0.1 kPa

### Part number

PST	—	13	—	<b>Measuring range</b> 11: -100/+100 Pa 12: -1000/+1000 Pa 13: -10,000/+10,000 Pa 14: -500/+500 mbar 15: -2000/+2000 mbar	<b>Example: PST – 13</b> Manostat PST with measuring range from -10,000 to +10,000 Pa
-----	---	----	---	--	--

### Technical specifications

Output	1 RCR relay. NO (normally opened): 5 A/NC (normally closed): 3 A/240 Vac. Common mode voltage <30 Vac
Power supply	24 Vac/Vdc $\pm 10\%$
Consumption	3 VA
Relay and alarm status	Red led in front and internal buzzer (70 dB at 10 cm)
European directives	2014/30/EU EMC; 2014/35/EU Low Voltage; 2011/65/EU RoHS II; 2012/19/EU WEEE
Electrical connection	Terminal block for cables $\varnothing$ 0.05 to 2.5 mm <sup>2</sup> . Carried out according to the code of good practice
PC communication	USB-mini Din cable
Environment	Air and neutral gases

\*All the accuracies indicated in this technical datasheet were stated in laboratory conditions, and can be guaranteed for measurements carried out in the same conditions, or carried out with calibration compensation.

## General features

Unit of measurement	PST-11, PST-12 and PST-13: Pa, mmH <sub>2</sub> O, inWG, mmHG, daPa, kPa, hPa, mbar PST-14 and PST-15: mbar, inWG, mmHG, PSI, mmH <sub>2</sub> O, daPa, hPa, kPa
Response time	1/e (63%) 0.3 s
Autozero	Manual by push-button Automatic by solenoid valve (only on PST-11)
Type of fluid	Air and neutral gases
Tolerated overpressure	PST-11, PST-12: 21,000 Pa; PST-13: 69,000 Pa; PST-14: 1400 mbar; PST-15: 4100 mbar
Conditions of use (°C/%RH/m)	From 0 to +50 °C. In non-condensing condition. From 0 to 2000 m.
Storage temperature	From -10 to +70 °C

## Features of the housing

Material	ABS V0 as per UL94
Protection	IP65
Display	LCD 10 digits. Size: 50 x 17 mm Height of digits: Values: 10 mm; Units: 5 mm
Connections	PST-11, PST-12, PST-13: Ribbed Ø 6.2 mm PST-14, PST-15: Security Ø 6.2 mm
Cable gland	For cables Ø 8 mm maximum
Weight	143 g

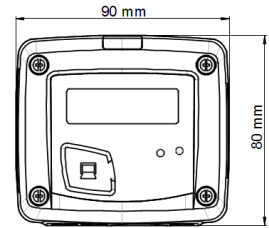
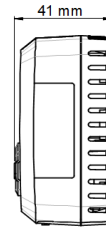

## Connections

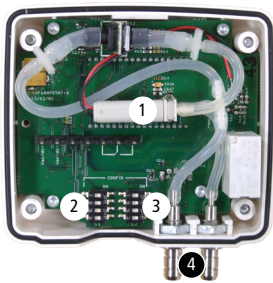

Inside the front housing



Removable front face

Fixed back housing

- |                                 |                              |                                 |
|---------------------------------|------------------------------|---------------------------------|
| 1. Solenoid valve (only PST-11) | 5. Autozero                  | 9. Relay terminal block         |
| 2. Switches                     | 6. LCC-S software connection | 10. Power supply terminal block |
| 3. Switches                     | 7. Alarm Led                 | 11. Cable gland                 |
| 4. Pressure connections         | 8. Button for settings       |                                 |



## Mounting

To mount the transmitter, mount the ABS plate on the wall (drilling: Ø 6 mm, screws and pins are supplied). Insert the transmitter on the fixing plate (see A on the drawing beside). Rotate the housing in clockwise direction until you hear a "click" which confirms that the transmitter is correctly installed.



Once the transmitter is installed and powered up, please make an autozero to guarantee the correct working of the transmitter in any position.

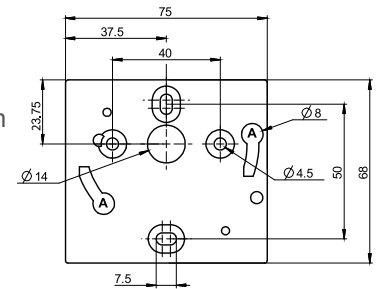

**Maintenance:** please avoid any aggressive solvent. Please protect the transmitter and its probes from any cleaning product containing formalin, that may be used for cleaning rooms or ducts.

**Precautions for use:** please always use the device in accordance with its intended use and within parameters described in the technical features in order not to compromise the protection ensured by the device.

## Accessories

Part number	Description
KIAL-100A	Power supply class 2, 230 Vac input, 24 Vac output
LCC-S	Configuration software with USB cable
Connection tubes / Connection fittings / Through-connections Straight connections / Spherical coupling nut	

 Only the accessories supplied with the device must be used.

## Warranty

Instruments have 1-year guarantee for any manufacturing defect.