

Dial Test Indicators

SERIES 513 – Vertical and Parallel Face Dial Test Indicators

- The vertical face indicator is useful for centering holes under a machine tool spindle using the universal holder mounted in the spindle chuck. (See page F-53.)
- The parallel face indicator is convenient to use when the application calls for stylus movement in a plane parallel to that of the dial face.



513-454-10E



513-452-10E



513-484-10E

Features

Metric		
Code No.		
513-454-10E	✓	✓
513-455-10E	✓	✓
513-484-10E	—	✓
Inch		
Code No.		
513-452-10E	✓	✓
513-453-10E	✓	✓
513-482-10E	—	✓

Optional Accessories

Swivel clamps, holding bars, stems and styli refer to pages F-51 to F-53 for details.

Dimensions

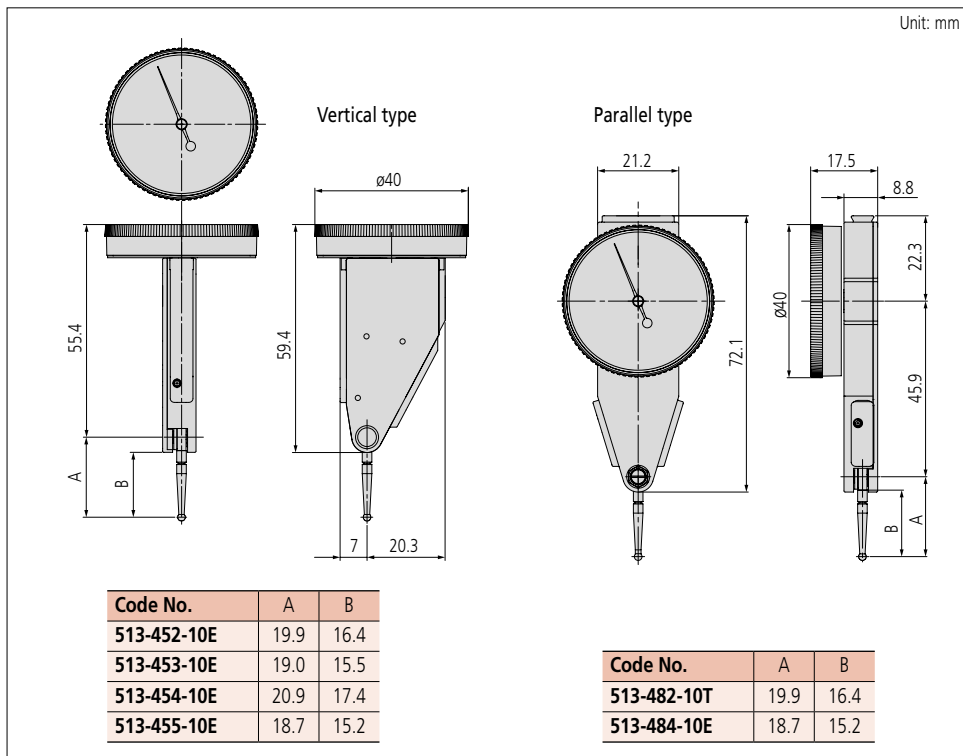

Set Configuration: Metric

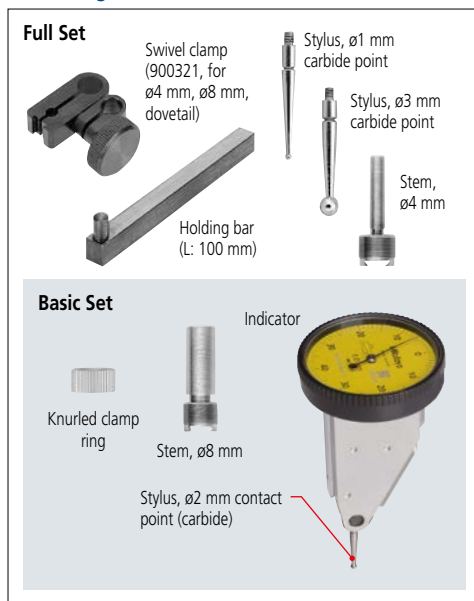

Set Configuration: Inch

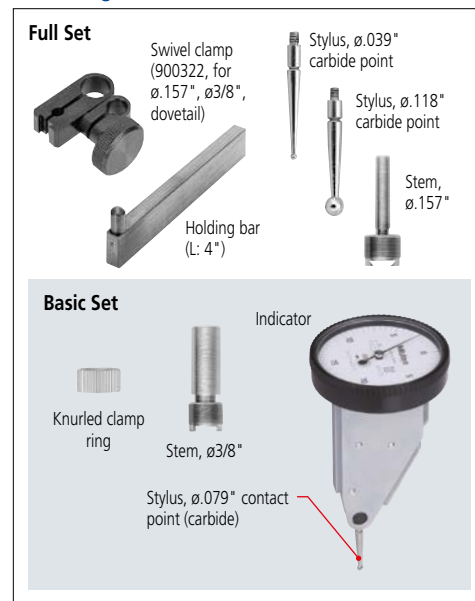

Specifications

Metric					
Code No.	Graduation	Range	Accuracy	Scale	Measuring force
Vertical type, basic set					
513-454-10E	0.01 mm	0.8 mm	8 µm	0-40-0	0.3 N or less
513-455-10E	0.002 mm	0.2 mm	3 µm	0-100-0	
Vertical type, full set					
513-454-10T	0.01 mm	0.8 mm	8 µm	0-40-0	0.3 N or less
513-455-10T	0.002 mm	0.2 mm	3 µm	0-100-0	
Parallel type, basic set					
513-484-10E	0.01 mm	0.8 mm	8 µm	0-40-0	0.3 N or less
Parallel type, full set					
513-484-10T	0.01 mm	0.8 mm	8 µm	0-40-0	0.3 N or less
Inch					
Code No.	Graduation	Range	Accuracy	Scale	Measuring force
Vertical type, basic set					
513-452-10E	.0005"	.03"	±.0005"	0-15-0	0.3 N or less
513-453-10E	.0001"	.008"	±.0001"	0-4-0	
Vertical type, full set					
513-452-10T	.0005"	.03"	±.0005"	0-15-0	0.3 N or less
513-453-10T	.0001"	.008"	±.0001"	0-4-0	
Parallel type, full set					
513-482-10T	.0005"	.03"	±.0005"	0-15-0	0.3 N or less